

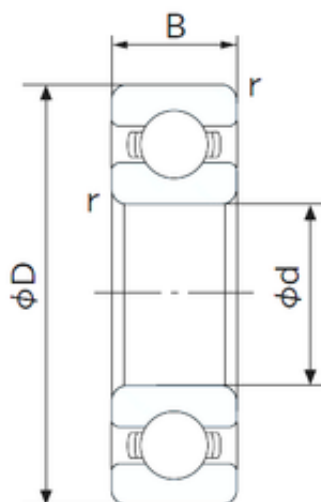

TIMKEN BEARING SALES PRIVATE LTD.



Koyo Timken Snr NTN NACHI 6000 6001
 6002 6003 6004 6005 6006 6007 6008 6009 6010
 6011 6012 6013 6014 6015 6016 6017 6018 6019
 6020zz/RS Deep Groove Ball Bearing

Bearing No. 6000

6000 Bearing 2D drawings and 3D CAD models

Size	10x26x8 mm
Bore Diameter	10 mm
Outer Diameter	26 mm
Width	8 mm
d	10 mm
D	26 mm
B	8 mm
C	8 mm
r min.	0.3 mm
da min.	12 mm
Da max.	24 mm
ra max.	0.3 mm
Weight	0.019 Kg
Basic dynamic load rating (C)	4,55 kN
Basic static load rating (C0)	1,97 kN
(Grease) Lubrication Speed	30000 r/min
Enclosure	Open
Bore Type	Cylindrical Bore
Configuration	Single Row
Bore Size	10 mm
Outside Diameter	26 mm
Width	8 mm
Fillet Radius/Chamfer	0.3 mm



TIMKEN BEARING SALES PRIVATE LTD.

Dynamic Load Rating	4,550 N
Static Load Rating	1,970 N
Limiting Speed - Grease	30,000 rpm
Limiting Speed - Oil	36,000 rpm
Factor f_0	12.4
Radial Clearance	0.002 to 0.013 mm
d_a (min)	12 mm
D_a (max)	24 mm
r_a (max)	0.3 mm